

**ITEM 8. MOBILE CRANES – TEMPORARY ROAD CLOSURES – LITTLE  
RILEY STREET SURRY HILLS**

**TRIM RECORD NO: 2016/668234**

**RECOMMENDATION**

It is recommended that the Committee endorse the temporary road closure of Little Riley Street, Surry Hills between Foveaux and Fitzroy Streets, on Tuesday 7 March 2017 from 7am to 3pm, subject to the following conditions:

- (A) The Applicant must comply with the temporary road closure conditions as mentioned in Schedule C of this Agenda.
- (B) The Applicant must comply with any other conditions imposed by City's Construction Regulation Unit.
- (C) The Applicant has indicated the Tuesday 14 March 2017 as an alternative date for the above work as a contingency for inclement weather.
- (D) The Applicant must contact Surry Hills Police to obtain a separate police permit and to discuss deployment of user pay police for the road closure.
- (E) If the above closure dates conflict with any works associated with the CBD and South East Light Rail (CSELR) project, Sydney City Centre Access Strategy (SCCAS) or any other major works or special events, they may be changed to new dates in consultation with the Transport Management Centre and Surry Hills Police.
- (F) The Applicant must provide a telephone number of the supervisor responsible for the proposed closure and include contact details in the notification letters to be distributed to affected stakeholders.

**VOTING MEMBERS FOR THIS ITEM**

<b><i>Voting Members</i></b>	<b><i>Support</i></b>	<b><i>Object</i></b>
City of Sydney		
Roads and Maritime Services		
NSW Police – Surry Hills		
Representative for the Member for Sydney		

**DECISION**

**BACKGROUND**

Icombined 360 has applied for the temporary road closure of Little Riley Street, Surry Hills between Foveaux and Fitzroy Streets, on Tuesday 7 March 2017 from 7am to 3pm.

**COMMENTS**

The proposed temporary road closure is required to allow a mobile crane to be used to replace telecommunication antennas at 88-90 Foveaux Street, Surry Hills.

The Applicant has provided a site-specific Traffic Control Plan that includes details of barricades, signs, flagmen and other traffic devices to implement the proposed road closure.

There are currently no other approved temporary road closures proposed to take place on the same day in close proximity of this closure.

The temporary road closure will not affect any other properties, as local access will be provided at all times and alternative access routes are available nearby.

A Traffic Management Plan (TMP) for the temporary road closure was approved by Roads and Maritime Services (RMS) on 18 January 2017.

### **CONSULTATION**

The Applicant will be required to notify affected stakeholders as stipulated in Schedule C.

### **FINANCIAL**

All costs associated with the proposed closure will be borne by the Applicant.

### **ATTACHMENTS**

Mobile Cranes – Temporary Road Closures – Little Riley Street Surry Hills

Michael Rimac, Engineering Traffic Officer

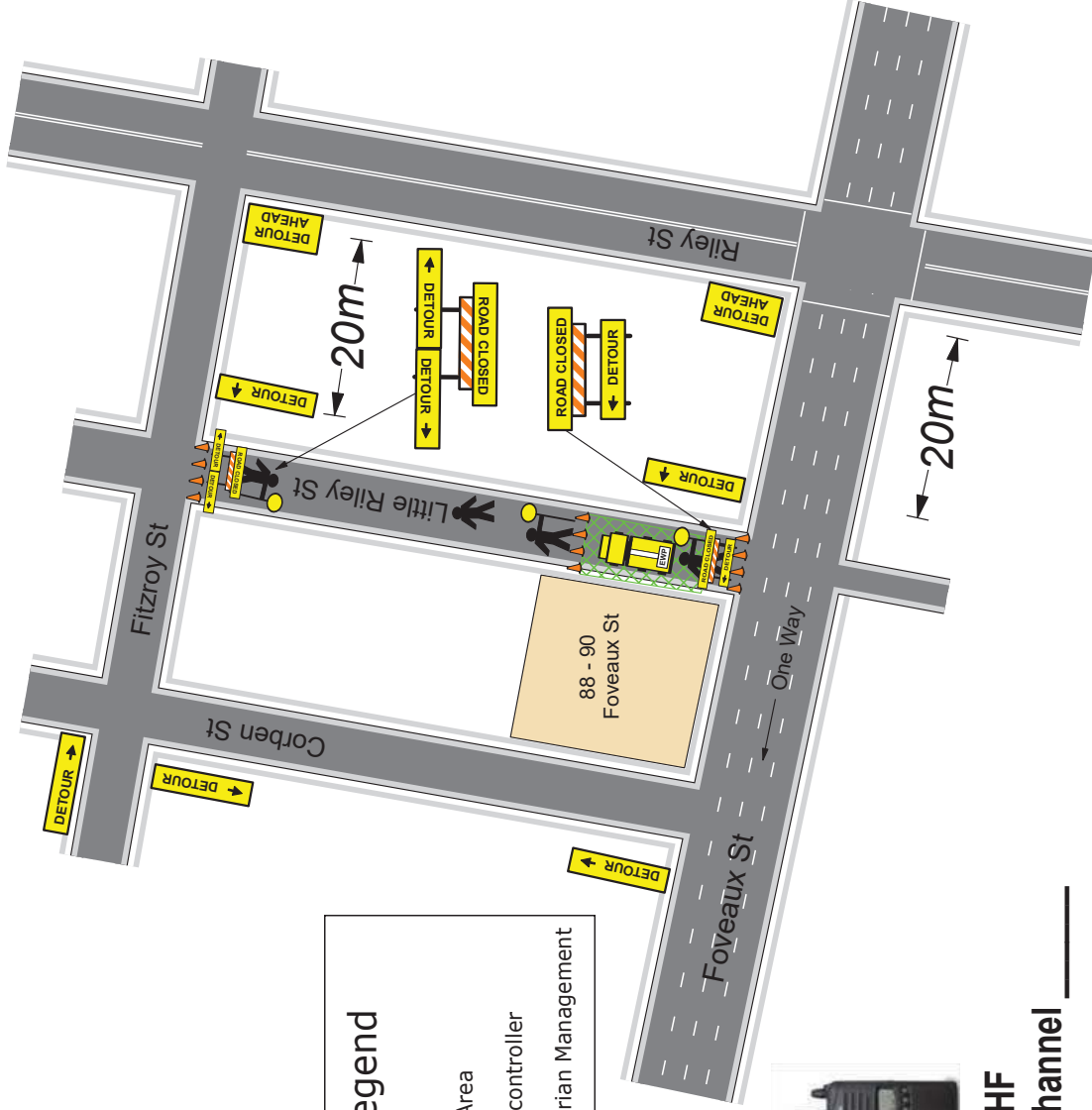

### Legend

- Cone
- Work Area
- traffic controller
- Pedestrian Management

- Notes:
- 1: D = 40m
  - 2: This is a short term works TCP.
  - 3: This TCP is based on RMS TCP 83 from the TCAWS manual.
  - 4: Ensure all council permit or road occupancy licence requirements are met.
  - 5: Cover all conflicting road signs where required.
  - 6: Cone spacing to be no greater than 6m apart
  - 7: Taper lengths shall be as stated in section 5.2
  - 8: 4 Traffic Controllers shall be required for this works
  - 9: An authorised person with a minimum current Select & Modify (Red Card) is to inspect the site before implementing this plan, if any changes are necessary mark any changes on the TCP & sign-off on the TCP.
  - 10: The site must comply with the Traffic Control At Work Sites manual V4 2010 edition and A.S. 1742.3.

Amendments:

Name: \_\_\_\_\_

Red Card Number: \_\_\_\_\_

Date: \_\_\_\_\_ Sign: \_\_\_\_\_

UHF Channel \_\_\_\_\_



		<p>DISCLAIMER: THIS SITE SPECIFIC TCP IS BASED ON RMS TCP AND IS TO BE SET UP, MODIFIED AND PACKED UP BY QUALIFIED TRAFFIC CONTROL PERSONNEL WITH CURRENT SELECT AND MODIFY TCP'S (RED CARD) AND CURRENT OHS (WHITE CARD) AS A MINIMUM REQUIREMENT. ANY MODIFICATIONS MADE TO THIS SITE SPECIFIC TCP MUST BE SIGNED OFF ON THIS TCP WITH CURRENT RMS CERTIFICATION NUMBER.</p> <p>NAME: _____ CARD NUMBER: _____</p>	
<p>DESIGNED BY: <b>JAMES DUNBAR</b></p>	<p>AUTHOR: <i>J. Dunbar</i></p>	<p>CLIENT: </p>	<p>CONTACT: NUMBER: N/A</p>
<p>RMS LIC NO: <b>3363016283</b></p>	<p>CO-SIGNED: <i>A. Buwana</i></p>	<p>TRAFFIC CONTROL PLAN: Little Riley St Surry Hills (Road Closure) TCP 753</p>	<p>SCALE: NOT TO SCALE</p>
<p>COMPLETION: <b>12-12-2016</b></p>	<p>EXP DATE: <b>06-05-2017</b></p>		
	<p>SHEET NO: <b>1 OF 1</b></p>		

